

Shah Alam Royal Theatre is one of Malaysia's landmark that is very unique in its shape and architectural structure compared to other buildings. It has tons of edges but has a very well-defined curve. This complexity brings out the modern look in a traditional way.

Inspired By

ROYALE THEATER SHAH ALAM

JEWELLERY BOX

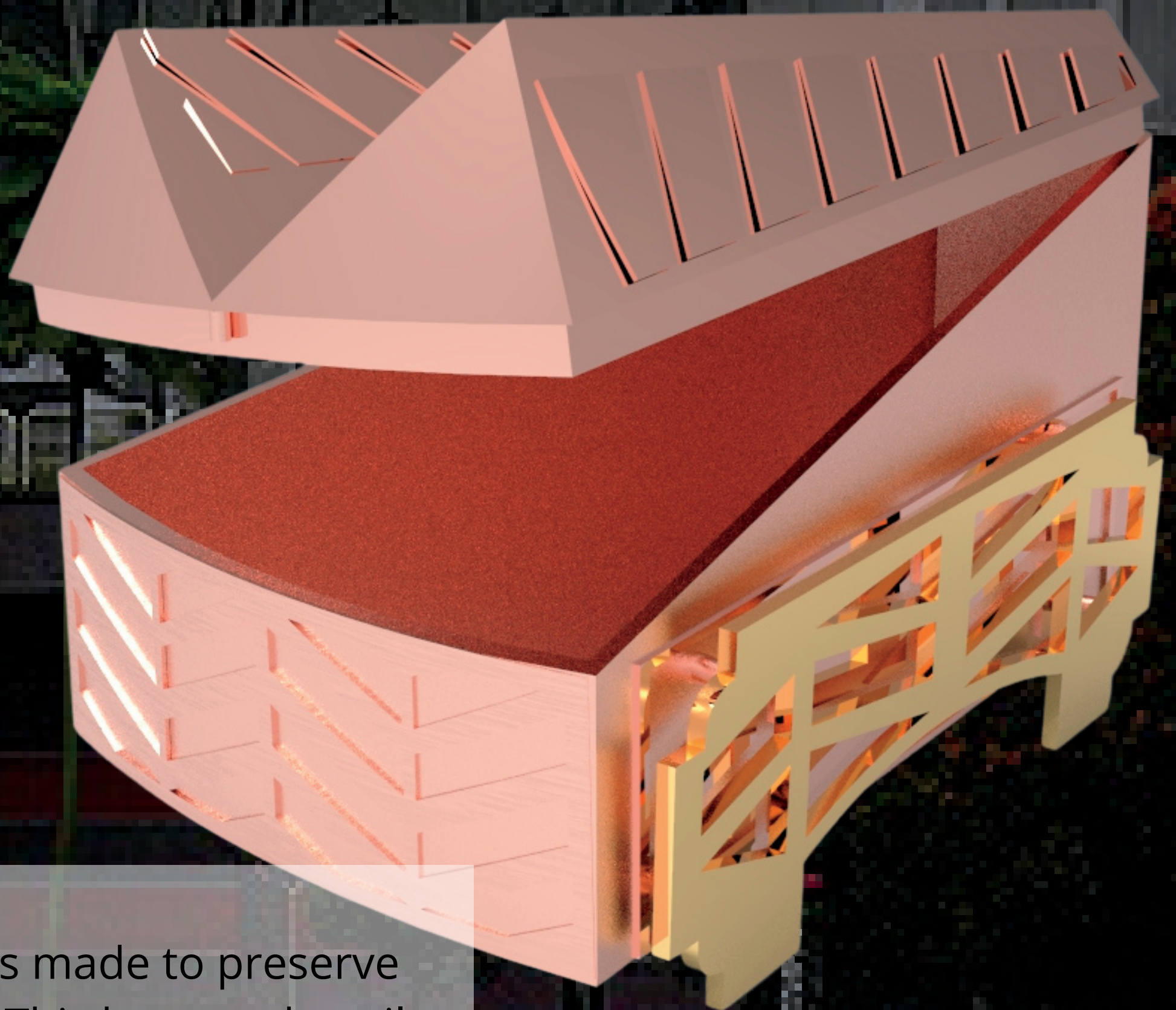
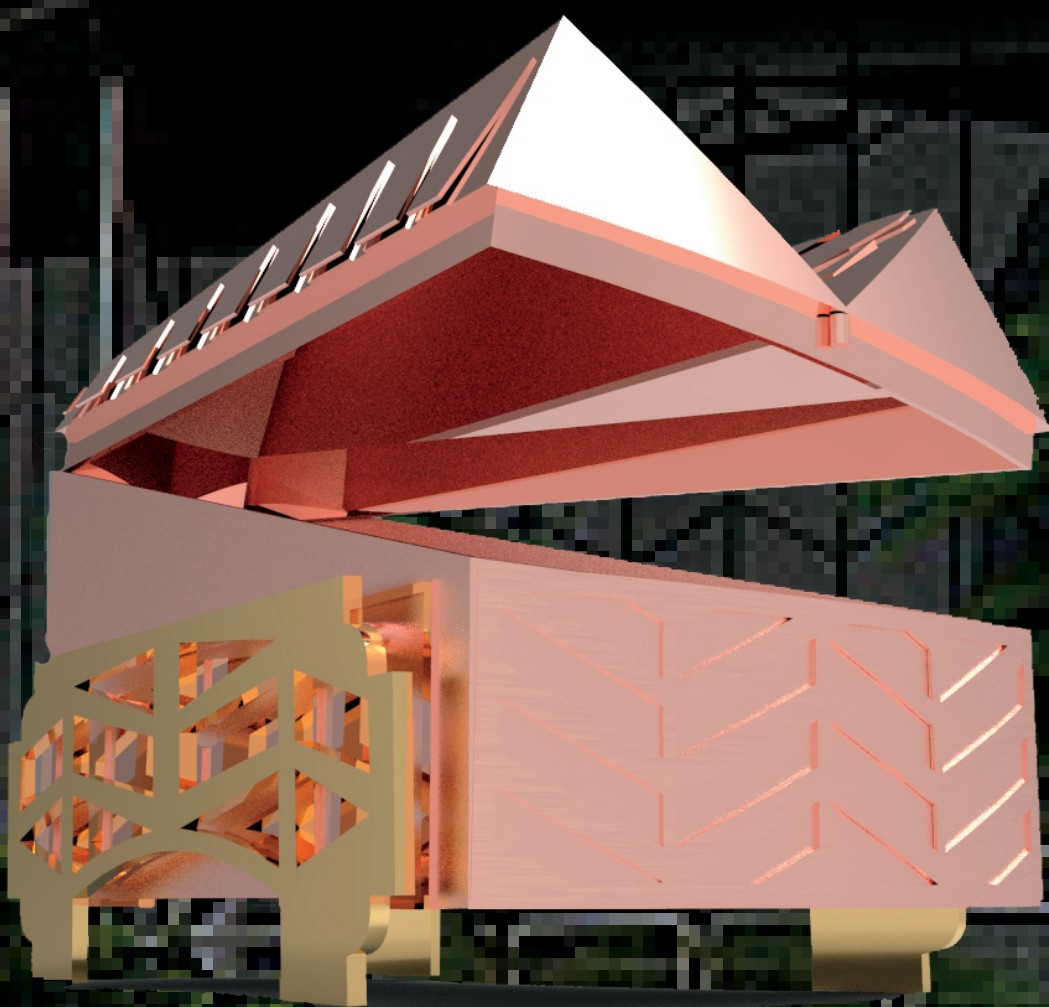

Jewellery Box is a box that was made to preserve the jewellery when not in use. This box was heavily inspired by this magnificent Malaysia building that is very rare in its geometry structure, making it look unique and outstanding.