

Chapter in Book

The Traditional Woodcarving Motif: Adaptation The Heritage on The Flash Drive Design

Normaisarah Bt Mohd Rosdi^{1,*}, Siti Aisyah Bt Muhammad², Azli B Abdullah³, and Muhammad Rizal Khairuddin⁴

¹ Ms ; i21d002f@siswa.umk.edu.my ;  0000-0003-0567-5560

² Dr; aisyah@umk.edu.my ;  ORCID ID (register at <https://orcid.org/>)

³ Ar; azli.ab@umk.edu.my ;  ORCID ID (register at <https://orcid.org/>)

⁴ Mr; rizal.k@umk.edu.my ;  ORCID ID (register at <https://orcid.org/>)

* Correspondence: i21d002f@siswa.umk.edu.my; 0199962795.

Abstract: *Rapid advancement of technologies and modern architecture also has imposed a risk overshadowing traditional kinds of learning architecture especially learning heritage including valuable arts and craft, traditional woodcarving. Woodcarving is a significant and valuable craft in Malay vernacular architecture with no architectural elements. Instead of lack of awareness, there is a very little work done in order to document and research the elements of woodcarving namely motifs, pattern, source, decorative manners, incision and philosophy in heritage buildings inasmuch of limited time, money and commitment. Therefore, this project was aimed to designed a cool, stylish, functional and impactful flash drive as one effort to preserving heritage building alongside keeps this traditional woodcarving arts and craft alive from generation to generation. Flash drive is a small electronic device containing flash memory that is used for storing data or transferring it to or from a computer, digital camera. It is a growing trend among people nowadays to utilize this device for storage, supplementary backups and also transferring computer files. Over recent years flash drive usage has gained great popularity and evolved into one of the most essential methods for files storage to minimize the computer drives in order to increase the productivity of the computer. Since this becomes trends among people to have at least one per person, the production of this flash drive has increased and being sold with various types of designs. therefore, this project aims to implement the design of traditional malay woodcarving into the flash drive as one of the effort to highlight these valuable arts. This project will be able to deliver various benefits for instance, preserving this heritage arts, educate community on malay woodcarving, reference for future research regarding this arts, and for the educational purpose about the traditional heritage of Malaysia.*

Keywords: woodcarving; flash drive; Istana Tengku Long.



Copyright: © 2022 by the authors. Submitted for open access publication under the terms and conditions of the Creative Commons Attribution (CC BY) license (<https://creativecommons.org/licenses/by/4.0/>).

1. INTRODUCTION

Flash drive is a small electronic device containing flash memory that is used for storing data or transferring it to or from a computer, digital camera. It is small external device that plugs into laptop, camera or phone in order to save digital data. The facts that everyone will face how much of bummer when it comes to technology fails or lost an important essay or misplaced hundreds of photos is undeniable. Therefore, this flash drives are external, it is count on always having a tangible way to access files from anywhere and anytime it is needed. This innovation was aimed to merge between this electronic devices and design of traditional woodcarving to appreciate and highlight these arts into

nowadays generation. Current design of flash drive that emphasizes lightweight and small enough to attach to lanyards or keychains to bring them easy to go. As the technology advances, its become the trends to custom the flash drive according to their taste and technology adaptation and hence slowly the identity of origin will be forgotten same goes to this valuable arts and craft, traditional woodcarving. Therefore, this project was conducted with the objectives to set a reference for student, researchers, academician, and tourist that interest in learning this valuable gems. Besides, this innovation is like a little effort for preserving and conserving traditional and heritage building from being forgotten. Lastly, this project was conducted to educate community to appreciate and keeps this traditional arts alive by merging this traditional woodcarving design into a flash drive.



Figure 1. The examples of current flash drive designs

2. METHOD & MATERIAL

This project was initiated to produce flash drive design with flexibility in mind. Firstly, a field survey has been conducted to Istana Tengku Long in order to documented the ornamentation at the palaces. The outcome from the site visit was then translated into 2d drawings by using Cad Software which later will be exported into pdf file in order to meet with the requirement from the laser cut machine. the drive then was translated with the customs carving that inspired from the palace itself. This innovation is suitable to be utilized in creating the momental for heritage building especially the one that have been demolished and this can be considered as one ways to keep it alive. This new invention of carving drive also draws upon its aims to contribute to appreciation of architectural heritage inasmuch indirectly, users will be attracted to dig deeper on woodcarving whenever they own this flash drive.

(a)

(b)

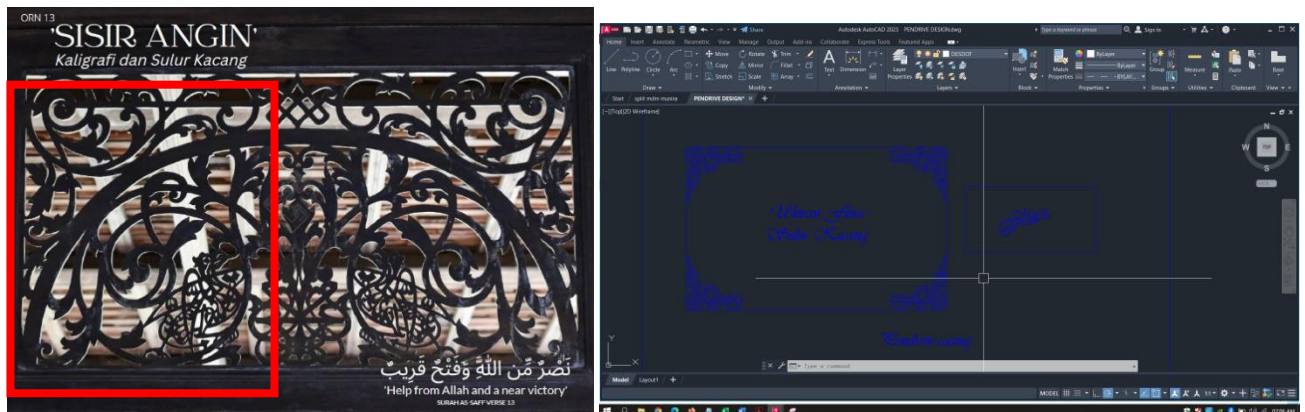

Figure 2. (a) 2D cad from Cad software was exported to pdf file (b) The carving drive after it was engraved using laser cutter machine

Source: Author (2022)

3. FINDINGS



Figure 3. (a) The woodcarving at Istana Tengku Long that was chosen for this innovation (b) The woodcarving then translated into 2D drawing using Cad Software
Source: Author (2022)

3.1 Istana Tengku Long

Traditional timber royal palace that located at Kampung Budaya Terengganu, Istana Tengku long was selected as case study as cited by (Zulkifli, 2007) traditional Malay royal palaces were prominent landmarks. Traditional Malay Royal Palaces played an important role in creating the architectural and cultural identities of local communities, and are hence linked to royal families effects. Istana Tengku Long has Malay Vernacular Architecture style and the structure of the palace is based on 'Rumah Limas Bungkus' or The House with Covered Pyramid Shaped Roof. This type of architecture originated from Britain and the Netherlands. At the beginning of 17th century the Riau archipelago established the style and was brought to Terengganu that uses Rumah Limas Bungkus structure as Istana Tengku Anjang and Istana Kolam. This palace was selected due to its history and availability of woodcarving at the palaces and considered as heritage building. "Heritage building" means and includes any building of one or more premises or any part thereof or structure or artifact which requires conservation or preservation for historical or architectural or artisanary or aesthetic or cultural or environmental or ecological purpose and includes such portion of land adjoining such building or part thereof as may be required for fencing or covering or in any manner preserving the historical and architectural and aesthetic and cultural value of such building. In traditional Malay vernacular palace architecture, woodcarvings was functioned to embellish hierarchy of space, wealth, social status and power for the peoples to see (Nurhana et al, 2020). There is an evident that the art of woodcarving is applied in an attempt reflects the phenomenal aspect of reality in a way that might be able to grasp the inner meaning behind the piece of art itself. Each art as applied in an artistic woodcarving has representative significance and the symbols in art play an important role in the design of art (Shamsidar et al, 2014).



Figure 4: Istana Tengku Long from perspective view (Measured drawing, 2022)

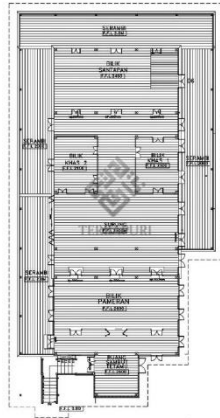
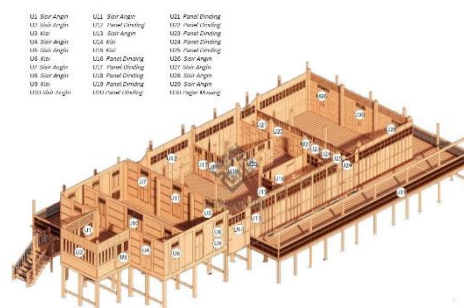

Figure 5. The floor plan of Istana Tengku Long. Source: Measured drawing (2022)

3.2 Traditional Woodcarving at Istana Tengku Long

In traditional Malay culture, there has always been a keen interest in the traditional art of woodcarving, even before the arrival of Islam. It is deemed as an architectural element that was used and designed to express the respect for Malay culture as its structure and complexity of design in the ornamentation serves as a symbol of high society status of a community. The carved panel was created for kings with the highest design qualities to represent values and status (Siti Aisyah, Azli & Normaisarah, 2022). Woodcarving is a process that requires the ability to transform a solid plank or block into relief and non-relief components, which is learned through apprenticeship. Woodcarving arts were prominent in palaces and homes of wealthy Malays. From the field survey, If viewed from the outside, this palace is not that impressive, but if we go inside and climb the four steps that lead to the wide balairong (central room), we will be faced with carvings that resemble a display of the creativity of Melayu craftsmen. According to Mr. Abdul Latif bin Long, most of the carvings in this palace were made by his father, Mr. Long. This has been certified true by Encik Wan Su bin Othman, a famous sculptor in Alor Lintah, Besut.

Each partition between the rooms has decorated nets around the four walls and each piece of carving is different. The ornaments around the King's private rooms are among the most delicate of his creations, including square decorations with four layers of carved leaves and branches which is a very unusual result of carpentry, which is called 'silap empat lapis'. It also contains carved pieces that combine calligraphy with leaf designs called 'Ayat Nasrun'.



4. DISCUSSION

This innovation of carving drive produces an electronic device that implementing woodcarving design from Istana Tengku Long. It is suitable to use for create a heritage building that have been demolish and keep it alive all the time. It can be as a reference to researchers that interested to conduct on certain detail especially on woodcarving study. Therefore, this new invention of carving drive draws upon its aim to contribute to appreciation of architectural heritage. Indirectly, this carving drive users will be attracted on woodcarving motif and its application.



Figure 3. Example of carving drive that implementing woodcarving elements at Istana Tengku Long.
Source: Author (2022)

With social media taking over the world, it is critical to be able to use these channels to distribute your material to the people. Technology visualization has a lot of potential in educate community on traditional crafts and keep it alive within time. Aside from giving people a glimpse of what woodcarving design and its motifs, this carving drive is a terrific approach to sell an electronic device that also benefits all types of people. This carving drive can be a source of income alongside as one of the effort to preserve this valuable heritage and arts from being forgotten.

5. CONCLUSION

The carving drive is invented where the users can customs design by taking references from the traditional woodcarving and avoid from using current trends of design. This project can later be expanded on a larger scale. It is developed as an effort to merge the traditional to an electronic device so that this traditional crafts will not be depleted from generation to generation. This also helps in preserving and conserving the traditional elements that located at Istana Tengku Long alongside educate community on this traditional crafts especially for new generation.

Acknowledgments: The authors acknowledge the Universiti Malaysia Kelantan and Ministry of Higher Education for supporting this project under the Fundamental Research Grant Scheme KPT FRGS/1/2021/SSI0/UMK/02/1.

References

- Abidin, N. Z., Shahminan, R. N. R., & Ibrahim, F. K. (2019). A Preliminary Study on the Architectural Influences of Istana Lama Seri Menanti, Negeri Sembilan. *IOP Conference Series: Materials Science and Engineering*, 620(1). <https://doi.org/10.1088/1757-899X/620/1/012084>.
- Ahmad, S. H., Taib, M. Z. H. M., & Masri, M. H. (2012). Istana Besar Tengku Long: Wall Carving Decoration and Motifs Influences the Spatial Social Interaction at Surung Area. *The 9th Regional Symposium of the Malay Archipelago*, December. <https://doi.org/10.13140/RG.2.1.4375.7605>.

- Baniyamin, N., Kassim, S. J., Jasmani, I., & Dzar, A. (2020). Geometricised patterns of the Malay world. July.
- Hanafi, Z (2007). Reka Bentuk Pola Hiasan Dalam Bangunan Tradisional Melayu. Dewan Bahasa dan Pustaka.
- Measured Drawing. Unpublished (2022). Istana Balai Besar: Measured Drawings. Department of Architecture, Faculty of Architecture and Ekistics (FSE), Universiti Malaysia Kelantan.
- Muhammad S A, Abdullah A and Rosdi M N 2022. The Potential Application Of Digital Documentation For The Traditional Malay Wood Carving In Balairung Seri, Istana Balai Besar. International conference of Current trends in islamic technology (CTiLT 2022).
- Rosdi M N, Muhammad S A and Abdullah A 2022. The Digital Documentation Of Wood Carvings As Symbolization Of The Royal Status At 'Balairung Seri', 'Istana Balai Besar'. International Conference On Science And Humanities (ICSSH 2022) (5 ; 2022 ;North Macedonia.